



BE-LOK INSTRUMENT FITTING
INC

Syphon

100% Factory Tested For Both Crack & Reseal



Engineering Expertise

@ www.be-lok.com

Accessories

Syphons and connecting pipes

For pressure measuring instruments Model 620.25



Compact Form



Trumpet form



U - Form

● Applications

- ☒ Cooling element for protection from excessive heating of liquids, gases and vapours
- ☒ Protection from pressure spikes and pulsations
- ☒ Direct process connection of pressure measuring instruments or in combination with other instrumentation accessories (e.g. valves)

● Special features

- ☒ Compact version suitable for vibration applications
- ☒ Customer-specific combination of valves and measuring instruments (hook-up) on request
- ☒ Permissible temperatures to 550 °C [1,022 °F]
- ☒ Nominal pressures to 420 bar [6,091 psi]

● Description

The geometries of the syphons in accordance with DIN 16282 are divided into U-form and trumpet form. These syphon versions are available with threaded connection (forms A and C) or weld-in connection (forms B and D) to the process side.

In addition to the standardised syphons, connections for NPT threads following DIN 16282 and industrial standard variants are available.

Inside the syphon, condensate is collected, which prevents the ingress of hot media into the pressure measuring instrument. It is recommended to fill the syphon with a cooling separating liquid before commissioning the pressure line

U-form syphons are intended for horizontal pressure tapping; trumpet-form syphons are intended for vertical pressure tapping.

The length-optimised compact form minimises the influence of vibrations and protects the pressure measuring instrument from pressure spikes and pulsations.

For applications that do not require a syphon, **BE-LOK** offers connecting pipes in a straight or angular form (pipe elbow 90°).

Pressure/temperature diagrams

Syphon: Trumpet form, U-form
Connecting pipe: Angular form

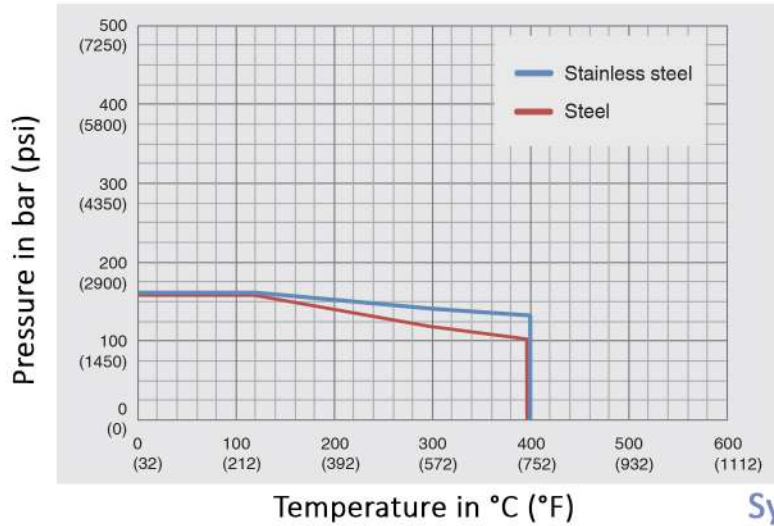

Syphon: Compact form

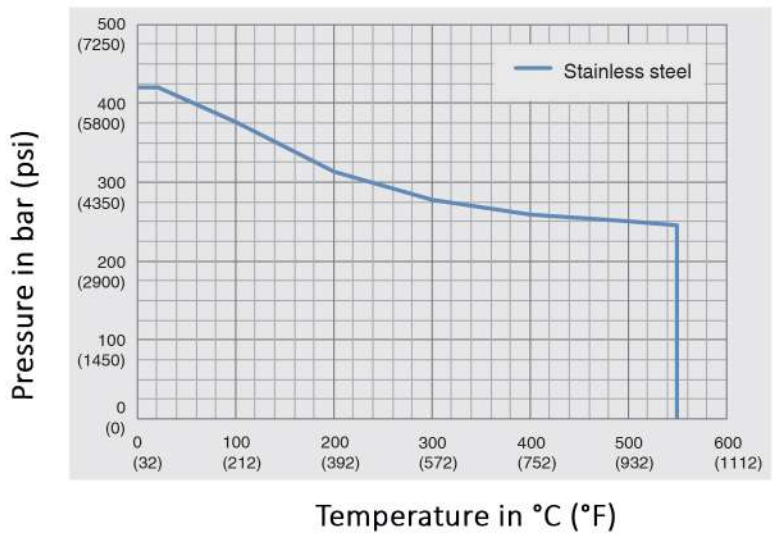

Connecting pipe: Straight form

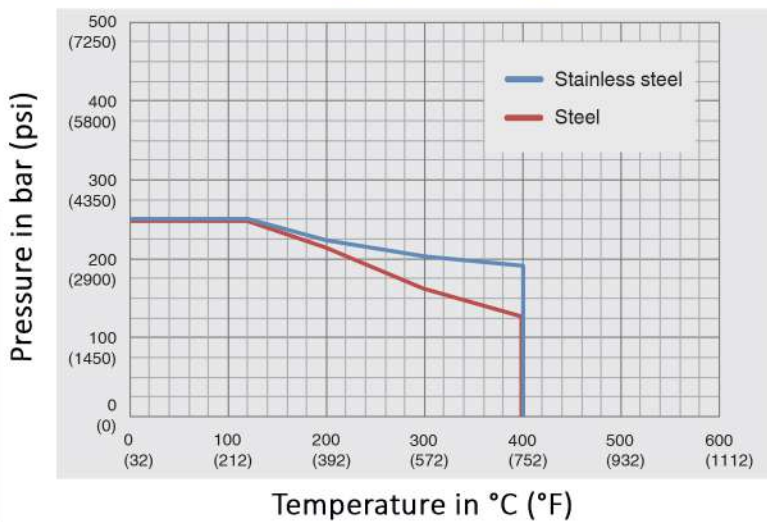

Designs per DIN 16282

Dimensions in mm [in]

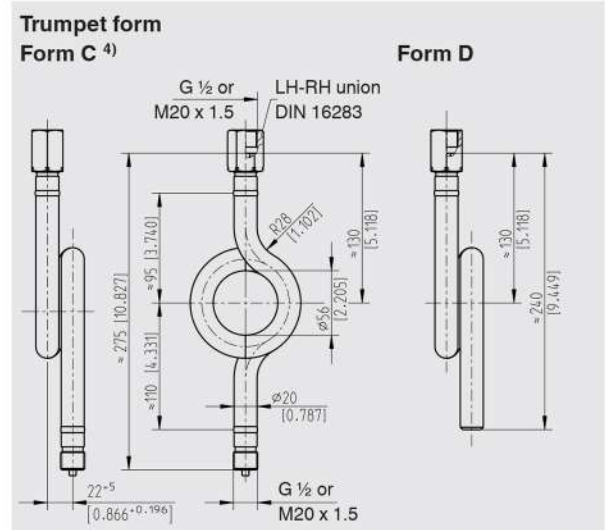
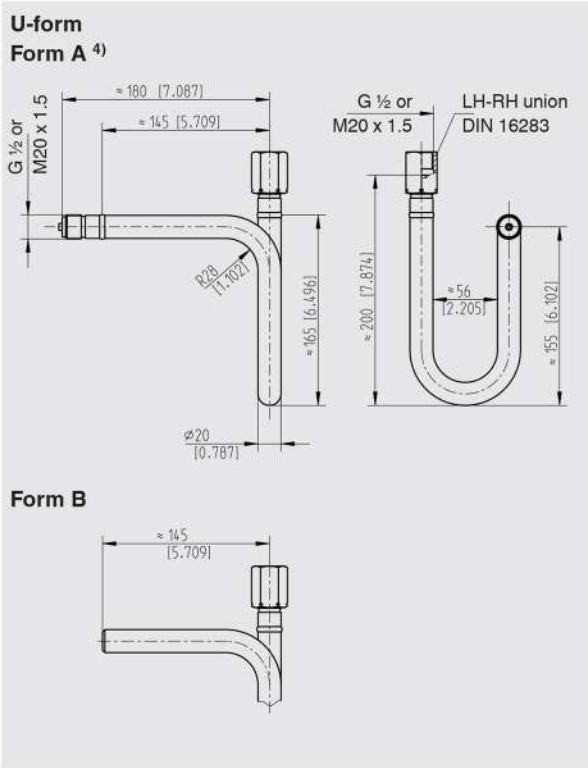

Due to the manufacturing process, the pipe dimensions at the bending points are slightly changed.

Version	Inlet 1)	Outlet 2)	Max. operating pressure in bar [psi]	Order number	
				Material of wetted parts	
				Steel 3)	Stainless steel 1.4571
U-form, form A 4)	G ½ B	G ½ LH-RH union	160 [1,450]	20512181	20621020
U-form, form B	Weld-in connection	G ½ LH-RH union	160 [1,450]	20512190	20621070
Trumpet form, form C 4)	G ½ B	G ½ LH-RH union	160 [1,450]	20512103	20621038
Trumpet form, form D	Weld-in connection	G ½ LH-RH union	160 [1,450]	20512111	20621097

- 1) Process side
- 2) Instrument side
- 3) Pipe: Steel 1.0345, process connection: 1.1141
- 4) Definition per DIN 16282 rev. 11/1988

Designs following DIN 16282

Connection thread deviating from G ½ B and M20 x 1.5

Dimensions in mm [in]

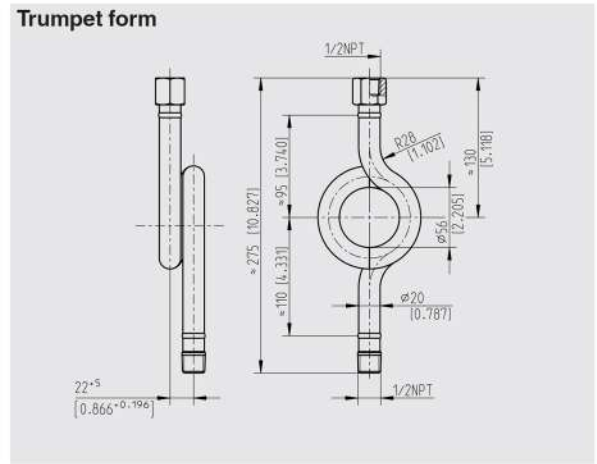
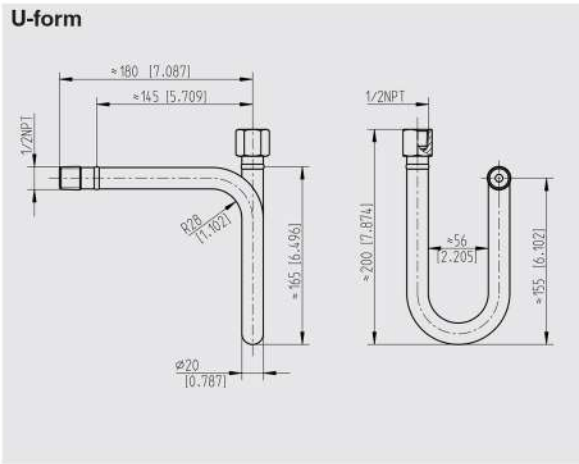

Due to the manufacturing process, the pipe dimensions at the bending points are slightly changed.

Version	Inlet 1)	Outlet 2)	Max. operating pressure in bar [psi]	Order number	
				Material of wetted parts	
				Steel 3)	Stainless steel 1.4571
U-form	½ NPT, male	½ NPT, fixed bushing	160 [1,450]	-	20621277
Trumpet form	½ NPT, male	½ NPT, fixed bushing	160 [1,450]	20512227	20621249

- 1) Process side
- 2) Instrument side

Industrial standard designs

Dimensions in mm [in]

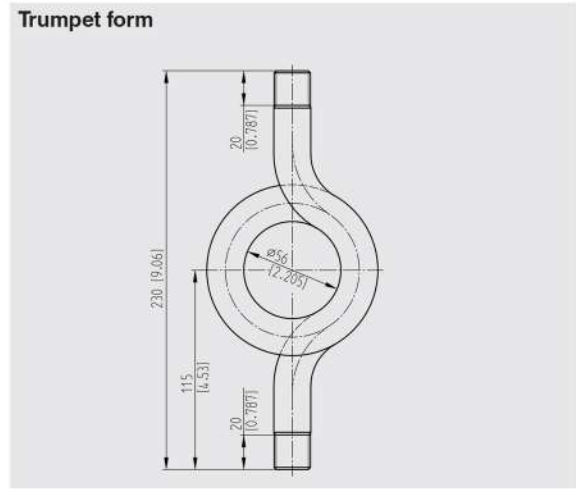
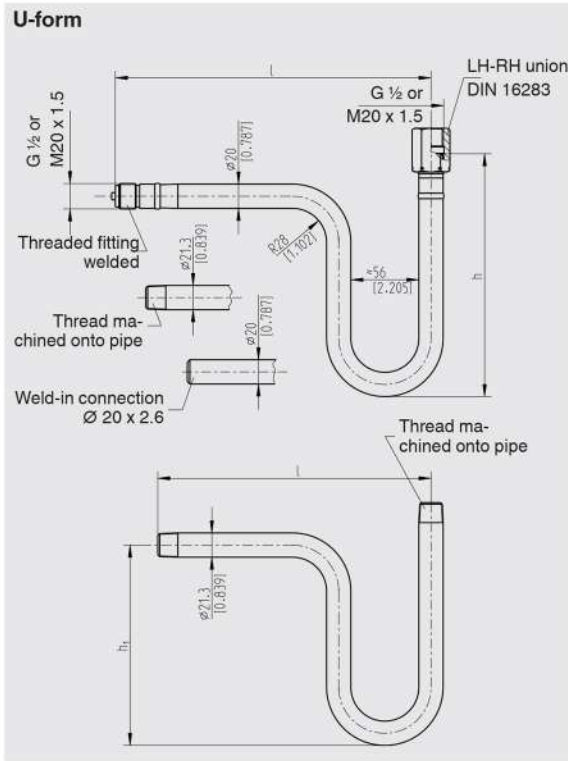

Due to the manufacturing process, the pipe dimensions at the bending points are slightly changed.

Version	Inlet 1)	Outlet 2)	Max. operating pressure in bar [psi]	Dimensions in mm [in]			Order number	
				l	h1	h	Material of wetted parts	
							Steel 1.0345	Stainless steel 1.4571
U-form	Weld-in connection	G ½ LH-RH union	160 [1,450]	218 [8.583]	155 [6.102]	200 [7.784]	8080681	16140265
U-form	G ½ B 3)	G ½ LH-RH union	160 [1,450]	253 [9.961]	155 [6.102]	200 [7.784]	8080673	-
U-form	G ½ B 4)	G ½ LH-RH union	25 [362]	225 [8.858]	150 [5.905]	205 [8.071]	8080665	-
U-form	G ½ B 4)	G ½ B 4)	25 [362]	225 [8.858]	150 [5.905]	170 [6.693]	8080657	16140775
Trumpet form	G ½ B 4)	G ½ LH-RH union	25 [362]	225 [8.858]	-	-	59522304	-

- 1) Process side
- 2) Instrument side
- 3) Threaded fitting welded
- 4) Thread machined onto pipe

Compact form

Dimensions in mm [in]

Fixed connection threads

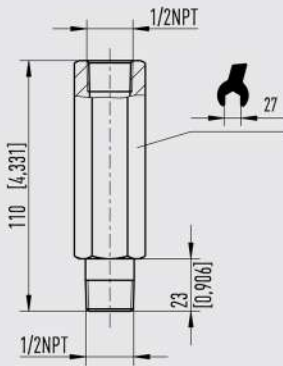

LH-RH union on instrument side

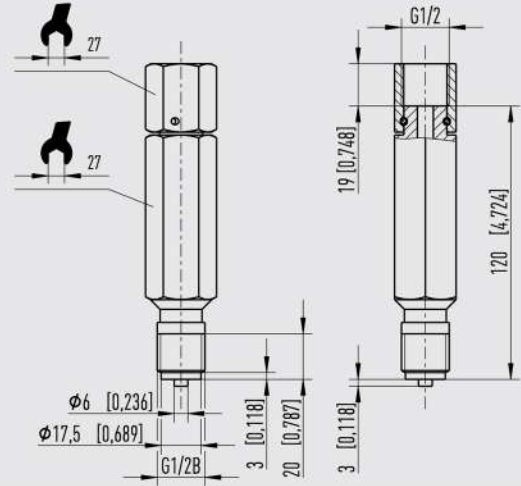

Version	Inlet 1)	Outlet 2)	Max. operating pressure in bar [psi]	Order number
				Material of wetted parts
Compact form	½ NPT, male	½ NPT, female	420 [6,091]	20621391
	G ½ B, male	G ½ LH-RH union	420 [6,091]	20621384

- 1) Process side
- 2) Instrument side

Connecting pipes for pressure measuring instruments

Dimensions in mm [in]

Straight form

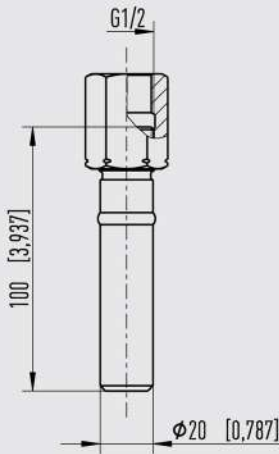

Angular form (pipe elbow 90°)

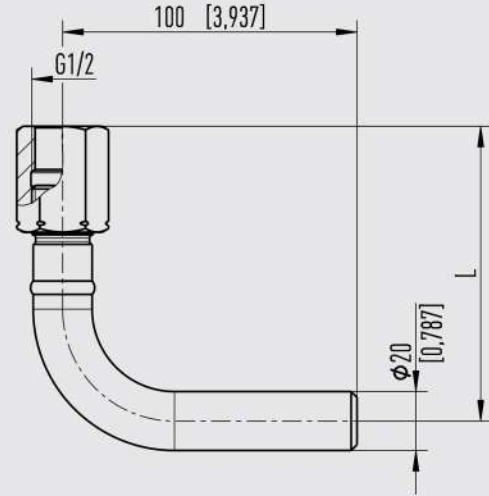

Due to the manufacturing process, the pipe dimensions at the bending points are slightly changed

Version	Inlet 1)	Outlet 2)	Max. operating pressure in bar [psi]	Order number	
				Material of wetted parts	
				Steel 1.0345	Stainless steel 1.4571
Straight form	Weld-in connection	G ½ LH-RH union	250 [6,091]	2543769	2113886
Angular form	Weld-in connection	G ½ LH-RH union	250 [6,091]	2543773	2113894

- 1) Process side
- 2) Instrument side

Ordering information

To order the described product the order number is sufficient. Options require additional specification.



BE-LOK INSTRUMENT FITTING INC

Corporate Address : #V-13 A, Qureshi Estate, Zilu Parab Road,
Near Chinchoti Naka, Village-Chinchoti, Naigaon,
District Palghar (401208), Maharashtra, India.
Tel : +91-9785579843,
+91-9156629351
Email : sales@be-lok.com, info@be-lok.com
Website : www.be-lok.com